

LPD-6/18-4S

Power Divider

Specifications

● Frequency Range:	6000~18000MHz
● Insertion Loss:	$\leq 1.2\text{dB}$
● Amplitude Balance:	$\leq \pm 0.3\text{dB}$
● Phase Balance:	$\leq \pm 4\text{ deg}$
● VSWR:	$\leq 1.5 : 1$
● Isolation:	$\geq 18\text{dB}$
● Impedance:	50 OHMS
● Port Connectors:	SMA-Female
● Power Rating as Divider::	20 Watt
● Surface Color:	BLUE

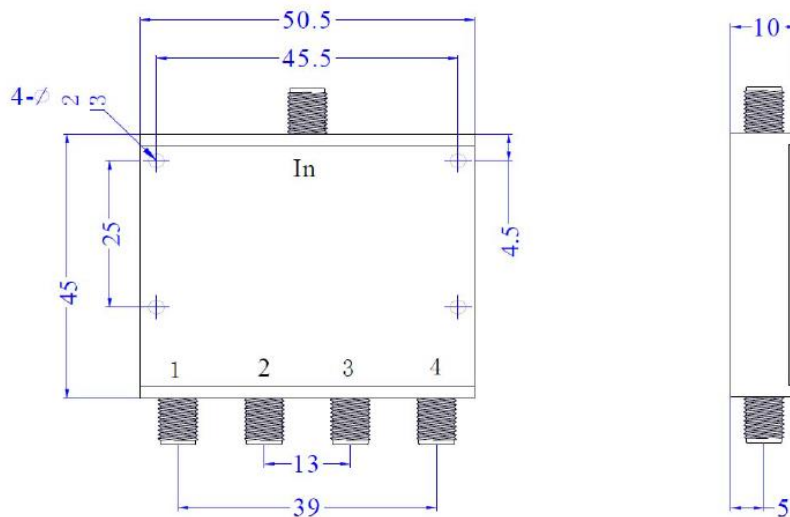

成都利德尔科技有限公司 ChengDu Leader Microwave Technology Co.,Ltd

电话: 028-65199117 传真: 028-65199116

<http://www.leader-mw.com> Leader-mw@hotmail.com

TEL: +86-28-65199117 FAX: +86-28-65199116

Add: 中国 成都市成华区华翰路 89 号 610000

No.89,Huahan Road, chenghua Zone Chengdu, Sichuan China Zip Code:610000